

FORMER DIE CAST AREA PCB CONTAMINATED SOIL EXCAVATION – 50ppm CLEANUP GOAL

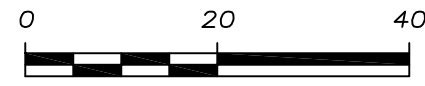
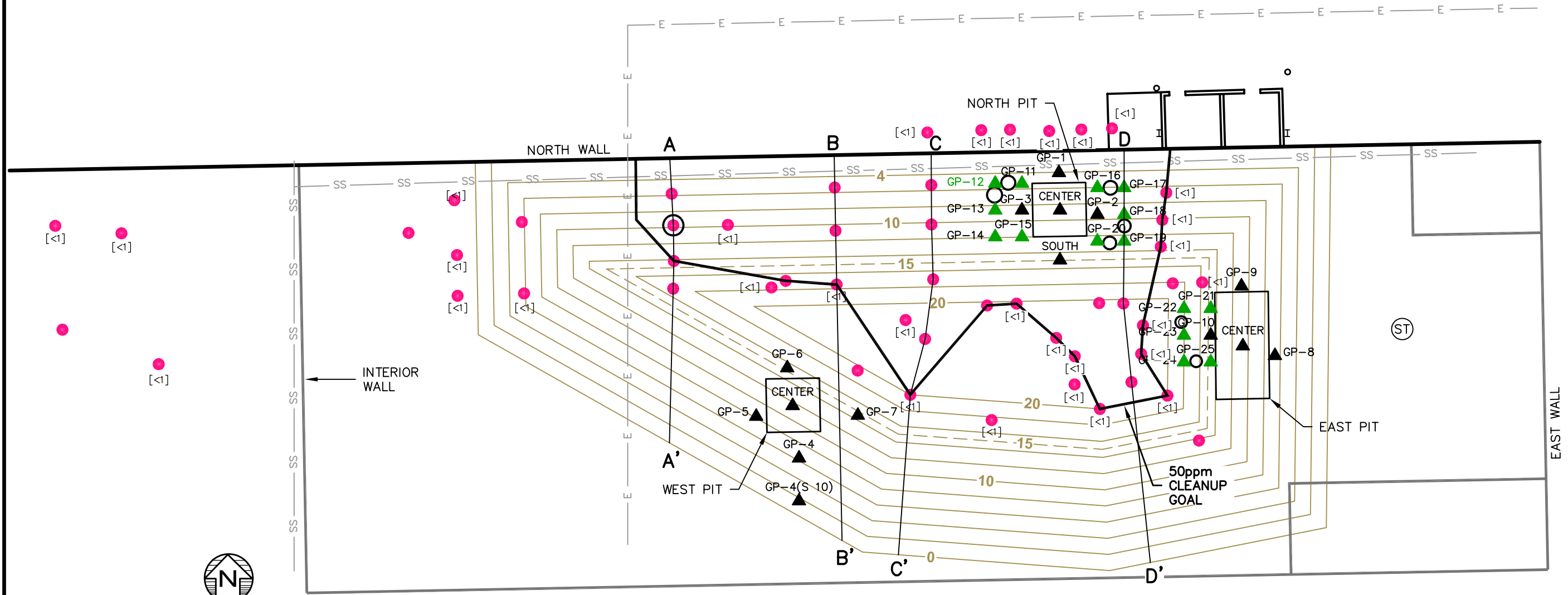

- LEGEND**
- (ST) STORM WATER CATCH BASIN
 - GP-7 ▲ SEPTEMBER 2015 GEOPROBE SOIL BORING LOCATION
 - ▲ DECEMBER 2015 GEOPROBE SOIL BORING LOCATION
 - AUGUST 2016 GEOPROBE SOIL BORING LOCATION
 - AUGUST 2016 CONCRETE SAMPLE LOCATION
 - [<1] RESULTS ARE LESS THAN 1 mg/kg FOR ALL SAMPLES COLLECTED AT THIS LOCATION

VOLUME OF MATERIAL > 50ppm EXCAVATED = 1,310 cu. yds.
 VOLUME OF MATERIAL < 50ppm EXCAVATED = 2,650 cu. yds.
 TOTAL VOLUME OF MATERIAL EXCAVATED = 3,960 cu. yds.

DRAFT

Drawn By
FAK
CADD Review
RMK
Date Drawn/Rev'd
8/29/2016



FORMER CHASE MANUFACTURING PROPERTY
 200 BLUE STAR HIGHWAY
 DOUGLAS, MICHIGAN
 Environmental Resources Management

CHK'D
AD
0356540
FIGURE 1

R:\Cadd\CintA-D\Buckman MacDonal0356540-02.dwg_PCB SOIL EXCAVATION_9/2/2016 3:17:29 PM_FAK