

FORMER DIE CAST AREA PCB CONTAMINATED SOIL EXCAVATION – 16ppm CLEANUP GOAL

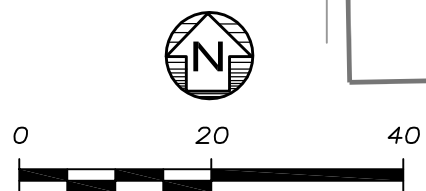
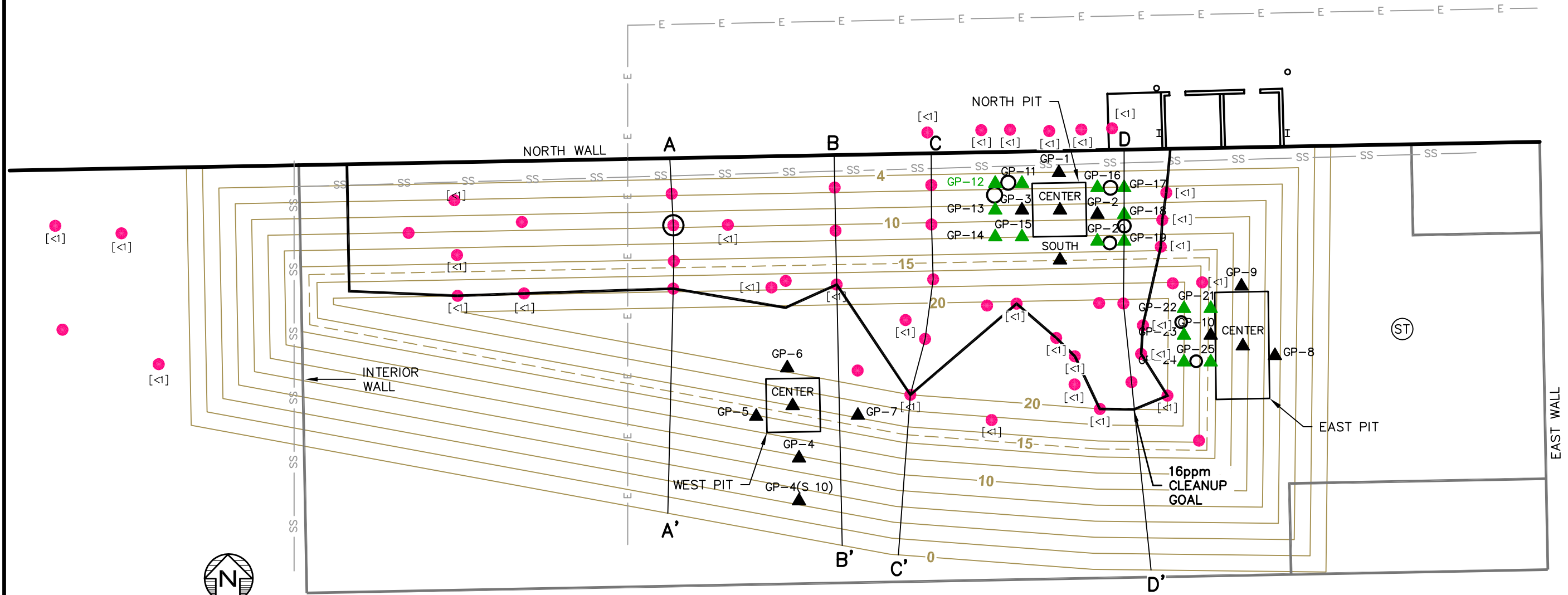

LEGEND

- (ST) STORM WATER CATCH BASIN
- GP-7 ▲ SEPTEMBER 2015 GEOPROBE SOIL BORING LOCATION
- ▲ DECEMBER 2015 GEOPROBE SOIL BORING LOCATION
- AUGUST 2016 GEOPROBE SOIL BORING LOCATION
- AUGUST 2016 CONCRETE SAMPLE LOCATION
- [<1] RESULTS ARE LESS THAN 1 mg/kg FOR ALL SAMPLES COLLECTED AT THIS LOCATION

VOLUME OF MATERIAL > 16ppm EXCAVATED = 1,941 cu. yds.
 VOLUME OF MATERIAL < 16ppm EXCAVATED = 3,736 cu. yds.
 TOTAL VOLUME OF MATERIAL EXCAVATED = 5,677 cu. yds.

DRAFT

Drawn By FAK
CADD Review RMK
Date Drawn/Rev'd 8/29/2016



FORMER CHASE MANUFACTURING PROPERTY
 200 BLUE STAR HIGHWAY
 DOUGLAS, MICHIGAN

Environmental Resources Management

CHK'D AD
0356540
FIGURE 3

R:\Cadd\CintA-D\Buckman MacDonal0356540-03.dwg, PCB SOIL EXCAVATION, 9/2/2016 3:26:57 PM, FAK