

FORMER DIE CAST AREA PCB CONTAMINATED SOIL EXCAVATION – 100ppm CLEANUP GOAL

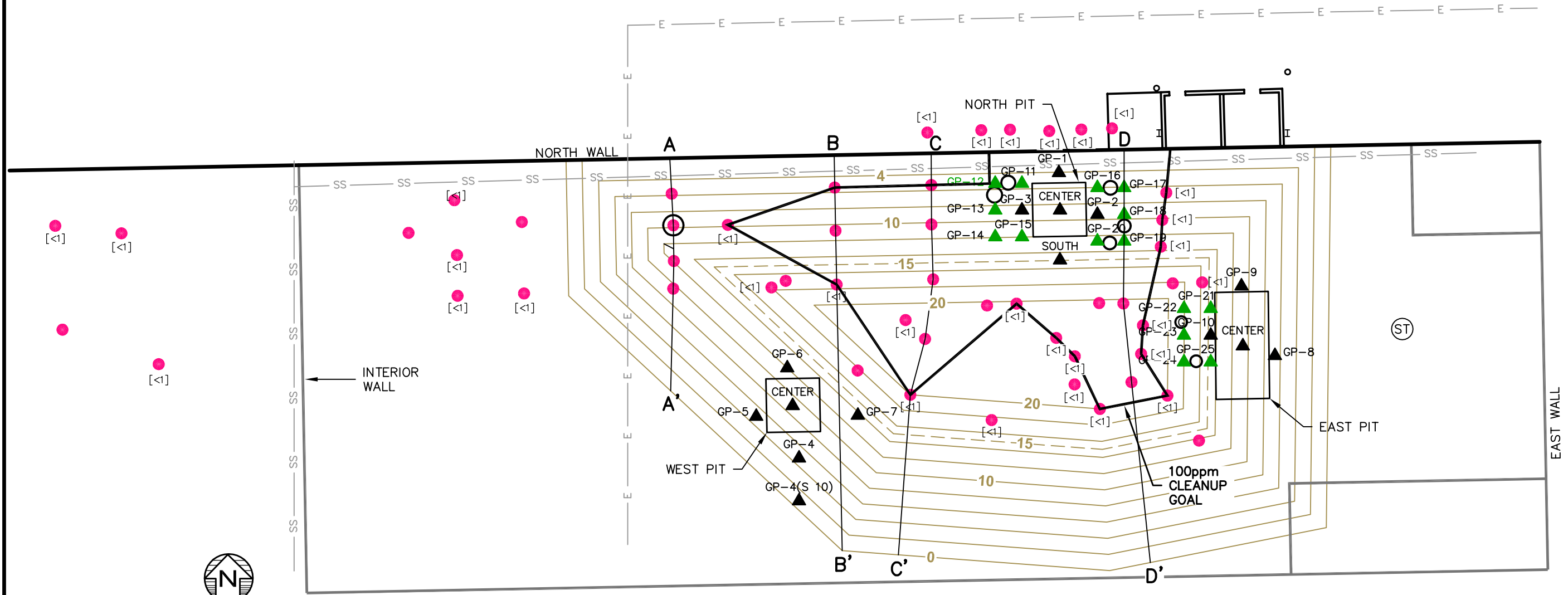

- LEGEND**
- (ST) STORM WATER CATCH BASIN
 - GP-7 ▲ SEPTEMBER 2015 GEOPROBE SOIL BORING LOCATION
 - ▲ DECEMBER 2015 GEOPROBE SOIL BORING LOCATION
 - AUGUST 2016 GEOPROBE SOIL BORING LOCATION
 - AUGUST 2016 CONCRETE SAMPLE LOCATION
 - <1> RESULTS ARE LESS THAN 1 mg/kg FOR ALL SAMPLES COLLECTED AT THIS LOCATION

VOLUME OF MATERIAL > 100ppm EXCAVATED = 1,144 cu. yds.
 VOLUME OF MATERIAL < 100ppm EXCAVATED = 2,404 cu. yds.
 TOTAL VOLUME OF MATERIAL EXCAVATED = 3,548 cu. yds.

DRAFT

Drawn By
FAK
 CADD Review
RMK
 Date Drawn/Rev'd
8/29/2016



FORMER CHASE MANUFACTURING PROPERTY
 200 BLUE STAR HIGHWAY
 DOUGLAS, MICHIGAN
Environmental Resources Management

CHK'D
AD
 0356540
 FIGURE 5

R:\Cadd\CIntA-D\Buckman MacDonal0356540-04.dwg_PCB SOIL EXCAVATION_9/2/2016 3:30:44 PM_FAK